

Knobs & Adjustable Ratchet Levers

These 6 prong polypropylene knobs are offered in both male and female thread types. Zinc plated steel stud or insert.

P/N (female)	P/N (male)	KNOB DIA.	THREAD	STUD LENGTH (male)
	IL200 M-4X75	1-9/16	1/4-20	3/4
	IL200 M-4X138	1-9/16	1/4-20	1-3/8
IL200 F-5	IL200 M-5X50	1-9/16	5/16-18	1/2
	IL200 M-5X75	1-9/16	5/16-18	3/4
	IL200 M-5X1	1-9/16	5/16-18	1
	IL200 M-5X150	1-9/16	5/16-18	1-1/2
IL201F-5	IL201M-5X75	2-3/8	5/16-18	3/4
	IL201M-5X75	2-3/8	5/16-18	1-1/2

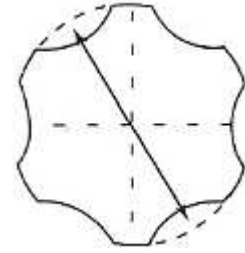

These 4 prong polypropylene knobs are offered in both male and female thread types. Zinc plated steel stud or insert.

IL204 F-4	IL204 M-4X75	1-9/16	1/4-20	3/4
	IL204 M-4X138	1-9/16	1/4-20	1-3/8
	IL204 M-5X50	1-9/16	5/16-18	1/2
	IL204 M-5X75	1-9/16	5/16-18	3/4
	IL204 M-5X1	1-9/16	5/16-18	1
	IL204 M-5X138	1-9/16	5/16-18	1-3/8
IL205 F-5	IL205 M-5X75	2-3/8	5/16-18	3/4
	IL205 M-5X150	2-3/8	5/16-18	1-1/2

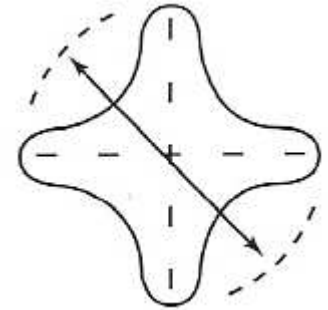

These 3 prong polypropylene knobs are offered in both male and female thread types. Zinc plated steel stud or insert.

	IL206 M-4X75	1-9/16	1/4-20	1-3/8
IL206 F-5	IL206 M-5X50	1-9/16	5/16-18	1/2
	IL206 M-5X75	1-9/16	5/16-18	3/4
	IL206 M-5X128	1-9/16	5/16-18	1-3/8
IL207 F-5	IL207 M-5X50	2-3/8	5/16-18	1/2
	IL207 M-5X75	2-3/8	5/16-18	3/4

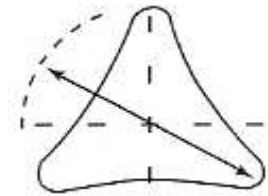

These circular phenolic knobs are offered in both male and female thread types. Zinc plated steel stud and brass insert. Height (H) of the 9/16 dia. knob is 5/8, (H) for 13/16" dia. is 7/8 tall

IL210 F-3F	IL210 M-3FX38	9/16	10-32	3/8
IL210 F-3	IL210 M-3X38	9/16	10-24	3/8
IL211 F-3	IL211 M-3X38	13/16	10-24	9/16
IL211 F-4	IL211 M-4X38	13/16	1/4-20	9/16

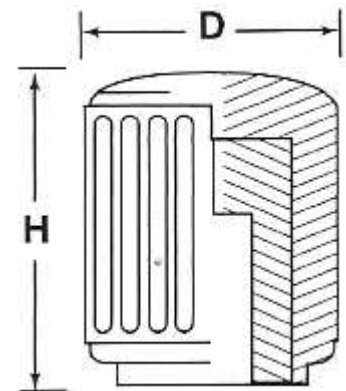

For adjustable leveling feet, furniture glides, caps, plugs, felt pads, bumpers, sliders, legs, vibration and noise reducers, visit our website at www.levelingmounts.com or call us at 562-597-4533



Knobs & Adjustable Ratchet Levers

These adjustable ratchet levers are offered in both male and female thread types. The handle is made of glass reinforced nylon. Zinc plated steel stud or brass insert.

Just push the red button to lift and rotate the ratchet handle. Especially useful for confined space locations or when extra clamping force is required.



P/N (female)	P/N (male)	Thread	A	B	C	D	L
IL220F-3	IL220 M-3X75	10-24	1-3/4	1-1/4	1	1/2	3/4
IL221F-4	IL221 M-4X75	1/4-20	1-3/4	1-1/4	1	1/2	3/4
IL221F-4		1/4-20	2-1/2	1-3/4	1-1/2	5/8	
IL222 F-5	IL222 M-5X118	5/16-18	2-1/2	1-3/4	1-1/2	5/8	1-3/16
	IL223 M-5X156	5/16-18	2-1/2	1-3/4	1-1/2	5/8	1-9/16
IL224 F-5	IL224 M-6X118	3/8-16	3-1/4	2-1/4	1-3/4	3/4	1-3/16
	IL225 M-6X156	3/8-16	3-1/4	2-1/4	1-3/4	3/4	1-9/16
IL226 F-5	IL226 M-6X118	1/2-13	4	2-5/8	2	1	1-3/8

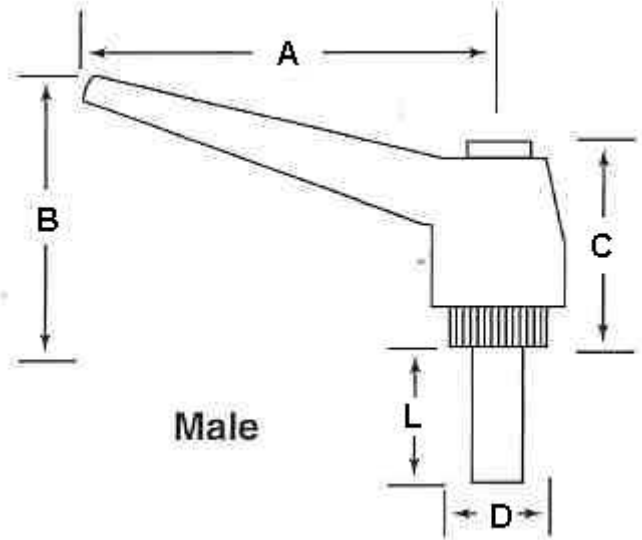

Male

These round phenolic ball knobs are offered in female thread with zinc plated steel insert or and press-fit hole types.

P/N (female)	P/N (hole type)	Thread	D	H	Hole depth	Press-fit stud
IL230 F-3F		10-32	5/8	9/16		
IL231 F-3	IL231H	10-24	3/4	11/16	1/2	3/16
IL232 F-4		1/4-20	3/4	11/16		
IL233 F-4	IL233 H	1/4-20	1	7/8	5/8	1/4
IL234 F-5		5/16-18	1	7/8		
IL235 F-5	IL235 H	5/16-18	1-1/4	1-3/16	9/16	5/16
IL236 F-6	IL236 H	3/8-16	1-1/2	1-7/16	3/4	3/8
IL237 F-7	IL237 H	1/2-13	1-3/4	1-11/16	13/16	1/2

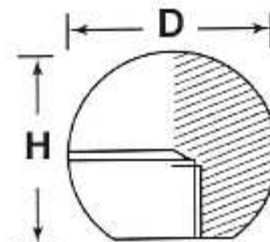

For adjustable leveling feet, furniture glides, caps, plugs, felt pads, bumpers, sliders, legs, vibration and noise reducers, visit our website at www.levelingmounts.com or call us at 562-597-4533